

Kaadas

Access to your Future !

Kaadas & Lamborghini Legends 3D Face User Manual

www.kaadasgroup.com

Shenzhen Kaadas Intelligent Technology co.,Ltd. reserves all rights for the final interpretation for this user manual.
And the manual is subject to be changed without notice.

Dear customers, thank you for using our smart lock.

Please check the package content and read the installation instruction carefully before you install this lock, and then install the product according to the instruction.

Our company will not assume any responsibility for direct or indirect product problems, other hazards and losses if you don't follow the instruction to install.

Contents

1 Important information

- Safety instruction
- Warning
- Disposal of used battery and lock

2 Install your smart lock

- Package content
- Explosive view
- Before installation
- Installation steps

3 Overview

- Front panel
- Back Panel

4 Set your smart lock

- Before you set up
- Enter Master mode
- Modify the master PIN code
- Add user face
- Add user PIN code

Add user fingerprint

Add user card

Delete user face

Delete user PIN code

Delete user fingerprint

Delete user card

System system

Record query

Energy saving mode setting

Auto mode setting

6 Other functions

- Emergency power supply
- Restore to default setting
- System reboot
- Replace battery

5 Use your smart lock

Unlock from outdoor

Unlock by mechanical key

Unlock by touching inside built-in sensor handle

Unlock from indoor

Volume Adjustment

Defence mode

Emergency Knob

1 Important Information

Safety instruction

- Read and understand all instructions before using this smart lock. Damages caused by failure to follow instructions is not covered by the warranty.
- It is recommended to use the enclosures/accessories specified by the company.
- Use only alkaline batteries configured with this product.
- Do not forcibly disassemble this product in order to avoid alarm sound or damage to the product.
- Do not scratch the fingerprint reader with sharp objects, otherwise it may cause permanent Long-term damage.
- Do not expose the product to corrosive substances, so as not to damage the outer protective layer.
- Do not hang objects on the handle, so as not to affect the normal use of the door lock.
- Cleaning the product, please wipe it with a soft cloth.
- Do not disassemble the battery while the device is operating.
- Please choose a professional engineer to install the door lock and follow the company's standard installation instruction , and do not install it by yourself .
- After the door lock is installed , please modify the default master PIN code immediately and keep the mechanical key in a safe place. Don't disclosure PIN code to the unknown person.
- When low battery alarm is triggered, please replace all the batteries in time.

Warning

- Do not place battery closing to fire in case of explosion .
- Do not short-circuit the two poles of the battery lead with metal objects to avoid explosion.
- Do not let it happened connection of two terminals of battery lead shorted with metal objects in case of explosion.
- Making sure replacement or maintenance are done by professional person authorized by Kaadas .
- Your warranty may invalidate if you used accessories produced by other manufacturer or not recommended by Kaadas.

Disposal of used battery and lock

- Please understand the local electronic product classification and collection system.
- Please follow the local regulations and do not discard used batteries into ordinary household garbage.
- Properly disposing of used products helps to avoid potential negative impacts on the environment and human health.
- The battery can not be disposed of with ordinary household garbage.

2 Install your smart lock

Package list

This Package list is for reference only, and all contents are subject to the actual packaging contents.

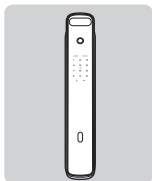

Front panel
(with rubber gasket)

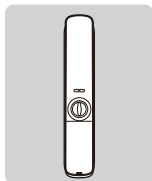

Back panel
(with rubber gasket)

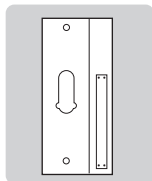

Installation template

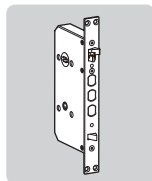

Mortise

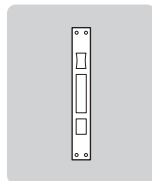

Strike plate

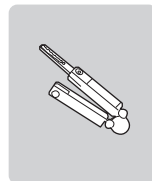

Mechanical key

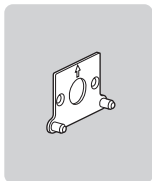

Mounting plate

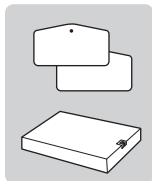

User card



Screw pack



User manual



warranty card

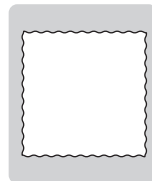

Micro fiber Wiper

Explosive view

Understanding the installation of a three-dimensional assembly drawing is beneficial to understand lock structure.

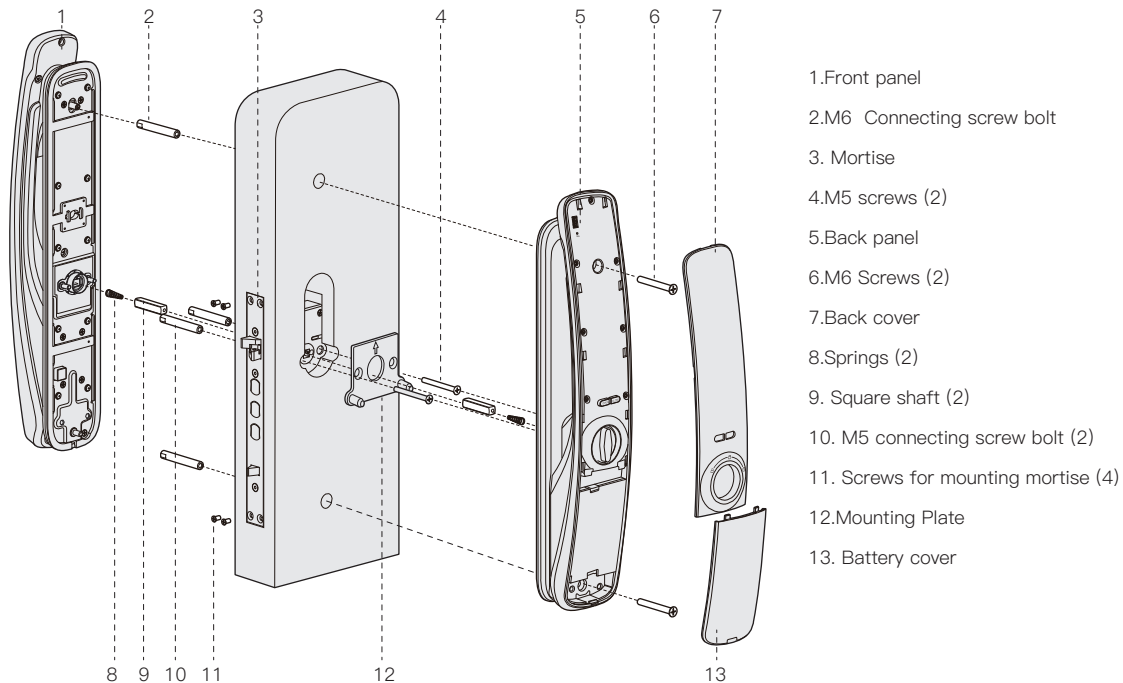

Before installation

Check door open direction before installation

Right-out open

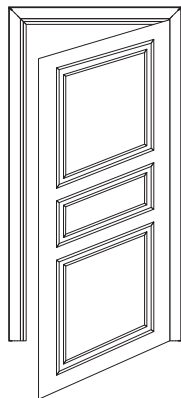

Right-in open

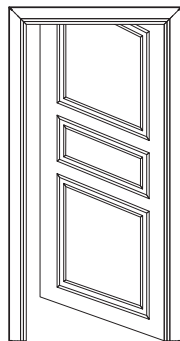

Left-out open

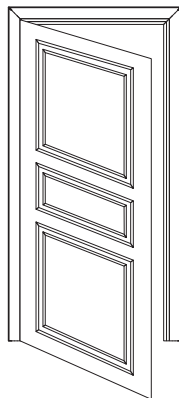

Left-in open

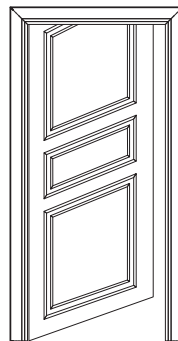

Installation steps

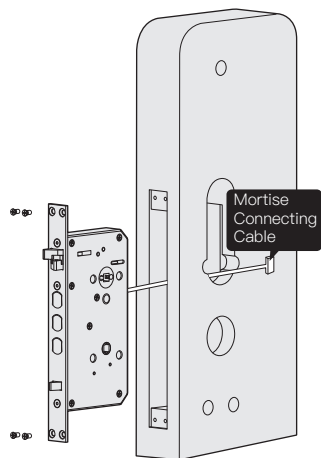

Drill bores following the installation template and then put the mortise into the door and tighten the four mounting screws.

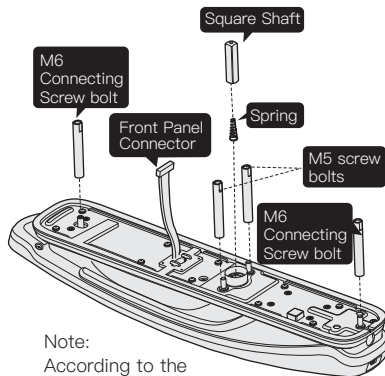

Note:
According to the thickness of the door, select the appropriate length square shaft and connecting screw.

Install the connecting screw bolt on the front panel, and put the pressure spring and square shaft in the hole.

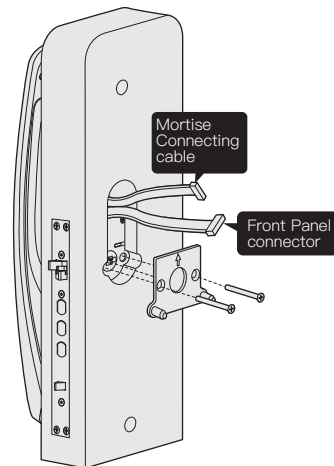

Pass the connectors and screw bolts through the bore on the door, and then insert the square shaft into the mortise follower of the front panel. Finally, mounting the front panel by mounting plate.

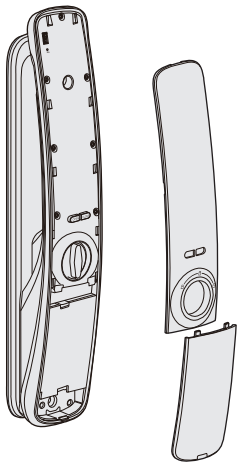

Take out back panel and battery cover.

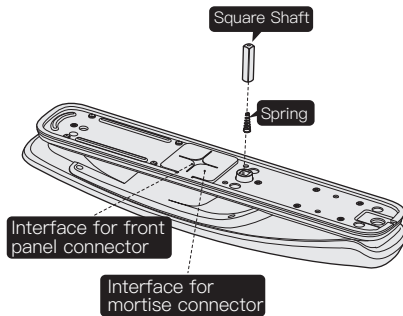

Insert the pressure spring and the square shaft into the hole of back panel. Then insert the front panel connector and mortise connector into the corresponding interfaces on the back panel.

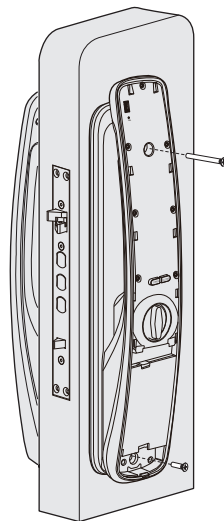

The excess cable plugs back the cable holes and then tightens the screws to fix the back panel.

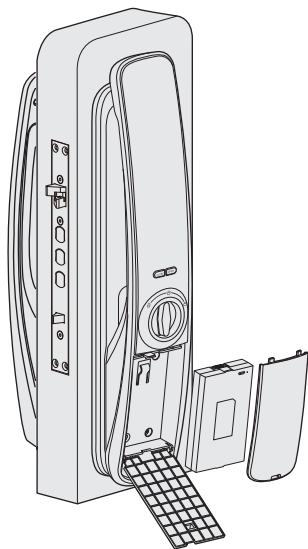

Install the back cover and lithium battery, then install the battery cover.



Check whether each part is installed well.

3 Overview

Front panel

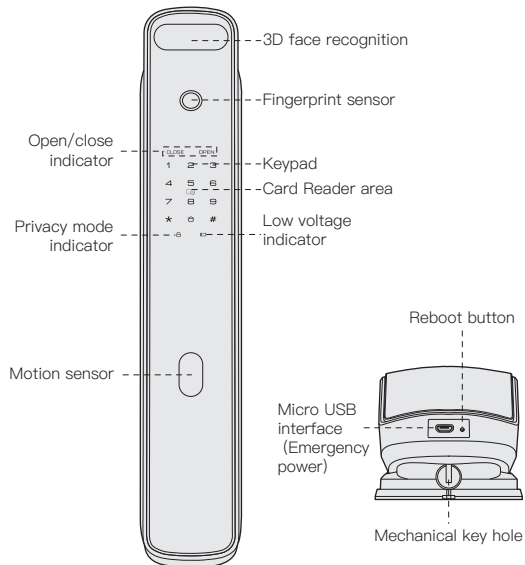

Back panel

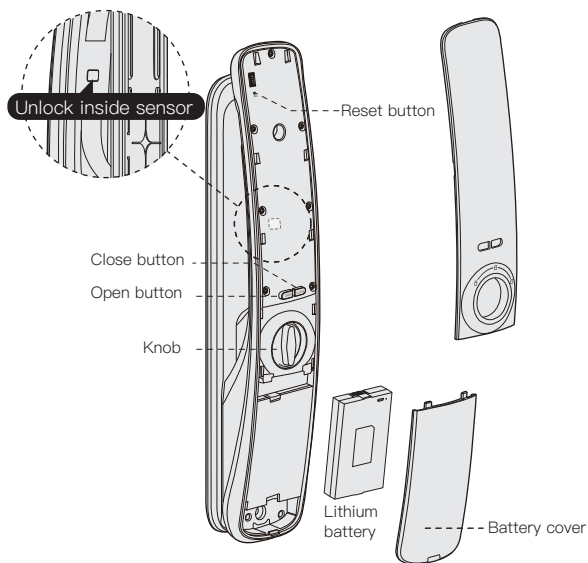

4 Set your smart lock

Before you set up

The system mode of the smart lock is divided into security mode and common mode, and the default system mode is a common mode. Security mode : dual verification is required (facescan + pin code , facescan +fingerprint , facescan+ card, Pin code+ fingerprint, Pin code + card , Card+ fingerprint); Common mode: single verification is OK (Pin code, card, fingerprint, facescan)

	Security mode	Common mode
Master pin code	the master code before entering master mode	the master code before entering master mode
User Pin code	One time pin code is not allowed to use	One time pin code is not allowed to use
User fingerprint	Yes	Yes
User card	Yes	Yes
User face	Yes	Yes
Method of entering master mode	Enter master pin code	Enter master pin code

 Note: Before setting up security mode, you have to enroll any two verification methods of fingerprint,Pin code and card. user Pin code is with fake pin code function, which means you can enter any two code before and after the real Pin code but it can't exceed 32 codes.

User Number

Under master mode , when you enroll face, PIN code, fingerprint and card , you should enter user number.When you need to delete single user , you can delete single user pin code according to user number .You can fill in the user information in this table for easy management :

User number	User name	Fingrtprint	PIN Code	Card	face
00					
01					
02					
03					
04					
05					
06					
07					
08					
09					

Enter master mode

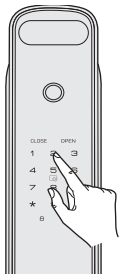

- 1.Touch the keypad area to wake up the keypad.
- 2.Press * twice and enter the master PIN code (default is12345678) with # key to confirm.
- 3.Voice prompt: master mode.

Note:

If the master pin code is default , please change to a new master pin code first.

Enter master mode

Under master mode:



Press 1 for user setting, then press 9 to modify the master PIN code.



Enter the new master PIN code and press # key to confirm , then repeat the above operation again . Voice prompt : settings succeeded.

Enroll user face

Under master mode:



Press 1 for user setting, then press 1 to enroll user face. Enter 2 digital user number and press # to confirm.



Please follow the voice prompts, stand one arm distance about 60cm, and look at the camera; and adjust the position according to the prompt till waiting for you to hear,After the voice prompt setting succeeded. it means that the user's face has been added successfully.

Enroll user PIN code

Under master mode:



Press 1 for user setting, then press 2 to enroll user PIN code. Enter 2 digital user number and press # to confirm.



Enter 6–12 digitals user PIN code and press #key to confirm , then repeat the above operation again. Voice prompt : setting succeeded.

Enroll User fingerprint

Under master mode:



Press 1 for user setting, then press 3 to enroll user fingerprint. Enter 2 digital user number and press # key to confirm.



Place your finger on the fingerprint sensor and then take away your finger after voice prompt “ remove your finger and scan again ”. Repeat the above steps until voice prompt

“setting succeeded.

00–94 is normal user, and 95–99 is duress user which works with wireless module and trigger alarm when duress event occurs.

Enroll User Card

Under master mode:

1 4  #

Press 1 for user setting, then press 4 to enroll card. Enter 2 digital user number with # to confirm.



Put the card closed to the card sensor area until one beep sound Voice prompt : Settings succeeded.

Delete user face

Under master mode:

1 5 1  #

Press 1 for user setting, then press 5 to delete user face. Press 1 to delete single user PIN code and enter 2 digital user number with # to confirm or stand far away around 60cm and look at the camera till Voice prompt : deletion succeeded.

1 5 2

Press 1 for user setting, then press 5 to delete user face. then Press 2 to delete all user face . Voice prompt : deletion succeeded.

Delete user PIN code

Under master mode:

1 6 1  #

Press 1 for user setting, then press 6 to delete user PIN code. Press 1 to delete single user PIN code and enter 2 digital user number with # to confirm . Voice prompt : deletion succeeded. Press 1 for user setting, then press 4 to delete user PIN code.

1 6 2

Press 1 for user setting, then press 6 to delete user PIN code. Press 2 to delete all user PIN code . Voice prompt : deletion succeeded.

Delete user fingerprint

Under master mode:

1 7 1  #

Press 1 for user setting, then press 7 to delete user fingerprint. Press 1 to delete single user fingerprint and then enter 2 digital user number with # to confirm or place finger on the fingerprint sensor until one beep sound. Voice prompt : deletion succeeded.

1 7 2

Press 1 for user setting, then press 7 to delete user fingerprint. Then press 2 to delete all user fingerprint . Voice prompt : deletion succeeded.

Delete user card

Under master mode:



Press 1 for user setting, then press 8 to delete user card.
Press 1 to delete single user card and then enter 2
digitals user number with # to confirm or put card deleting
closed to the card sensor until one beep sound. Voice
prompt : deletion succeeded.



Press 1 to enter the user settings, then press 8 to enter
the user card, and then press 2 to enter all the deletion,
the voice prompt is deleted successfully.

Voice setting

Under master mode:



Press 2 for system settings , then press 1 to set voice:
Press 1 to enter voice mode where all voice enables;
Press 2 to enter mute mode where voice disables
except alarm sound and voice guide under master mode.

Language settings

Under master mode:



press 2 for system setting, then press 2 to set language.
press 1 to set Chinese voice ,
press 2 to set English voice.

System query

Under master mode:



press 3 to enter system query, then press 1 to query
serial number. Voice reads serial number.

Extended function (optional)

Join the network

Under master mode:



Press 4 to enter extended function :
press 1 to join network;
press 2 to exit network.

Opening mode setting

Under master mode:



Press 5 for opening mode setting, then Press 1 for common
mode which means it can be unlocked by single verification
(Facescan, PIN code,card or fingerprint);
Press 5 for opening mode setting, then Press 2 for security
mode which means it is unlocked by dual verification
(facescan+ fingerprint, facescan+cad, facescan+Pin code,
PIN code + fingerprint, Pin code + card or card+ fingerprint).

Energy saving mode setting

Under master mode:

6 1

Press 6 for energy saving mode setting , then press 1 to enable energy saving mode. Voice promot energy saving mode entered.

6 2

Press 6 for energy saving mode setting , then press 2 to disbale energy saving mode,Voice promot energy saving mode exited.

Note:

In the energy saving mode , the facescan function is disabled . The lock will enter energy saving mode automatically when the battery is going to run out , which please changed full charged battery if you would enable the facescan function again.

Auto mode setting

Under master mode:

7 1

Press 7 for auto mode setting, then press 1 to enable auto mode in which the deadbolt will lock automatically when closed door.

7 2

Press 7 for auto mode setting, then press 2 to disable auto mode in which the deadbolt won't come out automatically when close door. (manual mode)

5 Use your smart door lock

Unlock from outdoor(Common mode)



When you close to the lock , the faces will be recognized automatically. After recognition succeeded , voice prompt door opened , then push or pull handle to open the door .

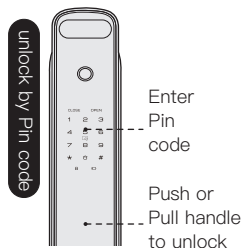

Touch the pad screen by palm to lighten keypad; then entering the enrolled PIN code with end of [#]. After voice prompt “door opened”, push or pull handle to open the door.

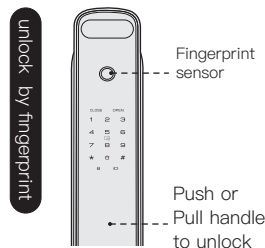

Place the enrolled finger properly on the fingerprint sensor area. After voice prompt “door opened”, push or pull handle to open the door.

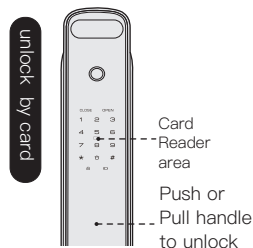

Place the enrolled card properly on the card icon area. After voice prompt “door opened”, pressing down the handle to open the door.

Note:

1. Under common mode, when you verify facescan, fingerprint , card or Pin code more than 5 times incorrectly , the lock will have a lockdown for 100S.
2. Under security mode, when you verify any two of facescan, fingerprint , card or Pin code more than 5 times incorrectly , the lock will have a lockdown for 100S.

Unlock by mechanical key

You can unlock by mechanical key if you forget pin code , the battery run out or system error occurs.

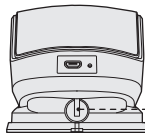

Mechanical key hole

Insert the mechanical key and then rotate 180°to unlock.
If your door is right opening direction, please turn the key clockwise.

Insert the mechanical key and then rotate 180°to unlock.
If your door is left opening direction, please turn the key counterclockwise.

Unlock by inside sensor handle



Unlock inside sensor

Inside sensor handle enabled , holding the inside handel and cover the sensor to unlock.

Inside sensor handle disabled, please press open button to unlock or enable sensor again.

Lock/unlock from in door

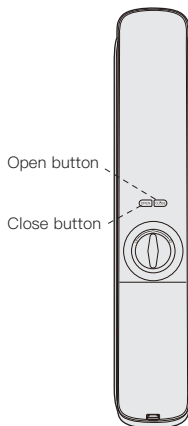

1. Locking button (close)
press the close button to lock,
long press the close button to enable
privacy mode.

In privacy mode , lock can be opened
only by master pin code or inside.

2.Unlocking button (open)
double press the open button to unlock

3.Enable/ disable the sensor of inside
hande,
long press open and close button
together to enable/disable the sensor
of inside handle.

Volume Adjustment



long press
button

when system is in voice mode , you can long press # button to turn off voice temporarily . it will recover once keypad waked up again.

when system is in mute mode , you can long press # button to turn on voice temporarily.it will recover once keypad waked up again.

Enable/ disable defense mode



Defense mode button

1.Enable: After closing door, press the defense mode button to enable defense mode. voice prompt: defense mode enabled. In defense mode, if someone unlocks from inside , the alarm will be triggered .

2. Disable: Defense mode will be disabled once it is unlock from outside.

Emergency Knob

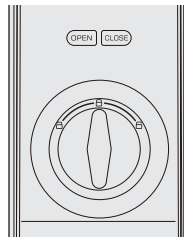

When system error occurs, you can rotate the knob tp unlock Indoor /Back Panel

Other Functions

Emergency power supply

When the battery voltage is too low to open the lock from outside, you can use 5V power bank to charge the door lock via Micro USB port. After the door is unlocked, please replace all batteries immediately. When battery voltage is lower than 4.8V, voice prompts "Low battery, please replace all batteries" at each unlocking. Please replace all batteries immediately, and do not mix old batteries and new batteries together in replacement.

Micro USB
interface
(Emergency
power)

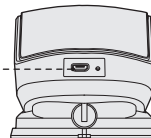

Restore to factory settings

If you forgot the master pin code, you can take out the battery cover then double press the Reset button till Voice prompts restored to factory setting , please modify the master pin code immediatley. It means reset succeeded.

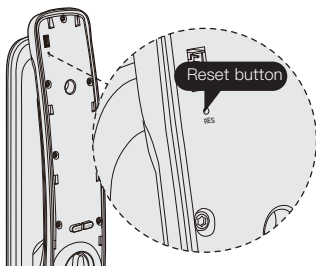

Battery charge

When the battery gonna run out , please charge the battery via 5V/2A power supply.

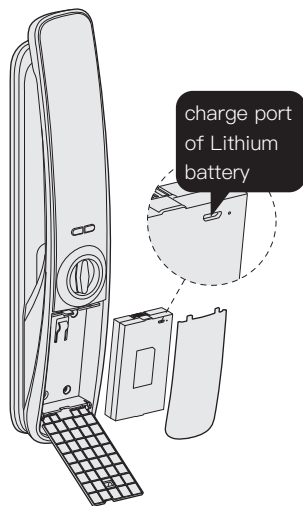

Sytem reboot

Press the reboot button to restart the lock, when the system error occurs . No user data is deleted.

